

OPERATION INSTRUCTION

Video intercom system

84207-C/EPC Series Outdoor Camera

User Manual

Appearance introduction

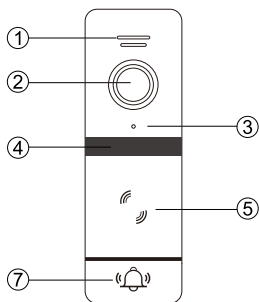
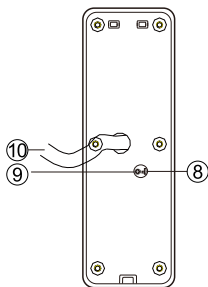
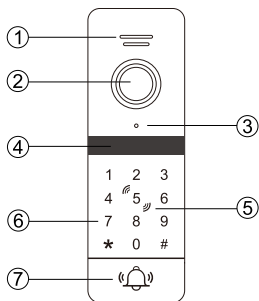

1	Speaker
2	Camera
3	Microphone
4	IR LEDs
5	Card Area
6	Digital Keypad
7	Call button
8	Signal Switch button
9	Volume regulator
10	System port

Notice: The signal switcher only available for signal switch lens, move up and down can be adjustable The signal switchable lens consists of two combinations: FHD and CVBS, AHD and CVBS.

Product Specification

	Analog Video Intercom System	AHD Video Intercom System	FHD Video Intercom System
Camera sensor	1/4 inch CCD/ CMOS camera	1/4 inch 1/3 inch CMOS camera	1/2.7 inch CMOS camera
View angle	90° /110°	90° /110°	130°
Definition(Hor.)	420/600/800TV Line	720P/960P	1080P
LEDs for night	IR LEDs(120)		
Operation temp	-40~+50℃		
Working current	Input DC:12V~+15V standby:≤30mA, working current ≤70mA		
Type of applicable card	IC card		
Interact distance, time	No Direction:≤3cm, Interact Time:≤2s		

Functions and Operations

1. Function

Support 200pcs IC card+200pcs passwords. Three types security unlock way: IC card, IC card or Password, IC card+Password

2. Capacity

200pcs IC card

3. Restore factory settings

Disconnected the power, long press unlock button and power on at the same time, move out unlock button after machine feedback "BI BI BI" three times. Factory restore successful.

Default password999999, Public unlock password 123456.

Unlock way default as card or passwords.

Unlock time default 2s.

Security mode default off.

In standby mode, keypad zone with soft button light, call button light off. After operation, keypad zone button light highlighted, and **the call button is always lit white light.**

When the machine during making call, monitoring or motion detection, the call button lights up red, unlock lights up in green.

Notice: After restore factory settings, all information from machine will be not cancel.

4. Master card management

1). Add master card

Through monitor add master card

Monitor on monitoring/calling/talking mode, after press unlock, long press outdoor station button 3S, BI BI BI three times sounds feedback and button slow flashlight, at the moment enter master card management mode. When monitor return to standby mode or outdoor station finished programme card, can be exit. During master card management, programme the first card is add master card(BI BI two times sounds means successful), the second card is delete master card (BI one time sounds, button light stop means successful and exit).

Through keypad programme master card (suitable for touch key function models)

Enter management mode, press 6 (button quick flashlight)+# at this moment enter master card management mode. Programme the first card is add master card(BI BI two times sounds means successful), the second card is delete master card(BI BI two sounds button slow flashlight, means successful and exit).

Notice: add master card and delete master card both with unlock function, in any mode support unlock directly. Master card failed delete, but can be instead of if add new master card.

2). Use master card programme other cards

With 10s punch 3times add master card enter programme mode (punch first and second feedback BI BI two times sounds, punch the third time feedback BI BI BI three times sound). At this moment punch new empty card start programme (if successful feedback BI BI , if failed feedback BI BI BI BI), punch again add master card exit (if no operation after 1min auto exit). If the card had been programme or delete master card, will be failed.

3). Use delete master card delete cards

During 10s punch 3times delete master card enter delete card mode(punch first and second feedback BI BI two times sounds, punch the third time feedback BI BI BI three times sound). At this moment, if punch card will be delete(when successful feedback BI

BI , if failed feedback BI BI BI BI), punch again delete mater card exit (if no operation after 1min auto exit). If punch add master card, will be delete all had been programme card (except mater card), at the moment, punch again delete master card seven times BI BI feedback exit; If punch the empty card, will be failed and exit delete card mode.

5. DVR video output

Enter add master card mode during brushing 3 times within 10 seconds(the first and second times of brushing are 2 sounds of didi, and the third time of brushing is 3 sounds of BI BI button light flashes slowly). After each brush of deleting the master card (two sounds of BI BI, an output will be made to enable switching on and off.

6. Password function introduction(suitable for touch key function models)

Enter management mode: press "*" + management password (default PW999999) + #, at this moment feedback "BI BI" two times and button slow flashlight means enter management mode. In this mode machine no operation within 30S, feedback "BI BI BI" auto return out management mode. During setting process, "BI BI" two times sounds means successful setting; if input wrong or setting failed, machine will feedback "BI BI BI BI" four times sound.

1). Revise management password, Public unlock password and Restore factory settings.

Management password: press 0 (button quick flashlight) + 77 + # NNNNNN (6digital PW) + # + NNNNNN (repeat again PW) + #.

Public unlock password: press 0 (button quick flashlight) + 11 + # NNNNNN (4~6digital PW) + # + NNNNNN (repeat again PW) + #.

Restore factory setting: press 0 (button quick flashlight) + 99 + # (BI, button slow flashlight), machine restore factory setting.

2). Programme IC card

Press 1 (button quick flashlight) + 000-199 + # + punch the card (BI BI two times feedback means add card successful; BI BI BI BI four times means add card failed). After add IC card system auto have default PW 0000", but the PW failed unlock, only use it for revise set new PW.

3). Delete IC card

Delete lose card

Press 2 (button quick flashlight) + NNN + # (NNN means from 000-199 any one card you want delete), BI BI BI three times feedback means successful delete card and PW.

Delete had been read cards

Press 2 (button quick flashlight)+read card, BI BI two times, means successful delete card and PW.

Delete all the cards

Press 2 (button quick flashlight)+88 + #(BI.....BI—seven times, button slow flashlight) means all information cancel.

4). Setting unlock mode

Press 3 (button quick flashlight)+00+# BI BI two times feedback, button slow flashlight) -----use card unlock.

Press 3 (button quick flashlight)+01+#(BI BI two times feedback, button slow flashlight) -----use card of PW unlock.

Press 3 (button quick flashlight)+02+#(BI BI two times feedback, button slow flashlight) -----use card + PW unlock.

5). Revised relay unlock time

Set unlock time on indoor monitor.

The unlock time can be saved after unlock one time from indoor monitor.

6). Security mode setting

Press 5 (button quick flashlight)+00+# (BI BI two times feedback, button slow flashlight) ----turn off security mode.

Press 5 (button light flashes) +01+# (BI BI two sounds, button light flashes slowly) -----
Lock mode: means that within 5 minutes, continuously brush invalid card or enter wrong password ten times, the machine will lock for 2 minutes, the button light flashes quickly and the indoor unit is automatically called. The button and card swiping are invalid during this time period. (except the call button)

Press 5 (button light flashes) +02+# (BI BI two sounds, button light flashes slowly) -----
alarm mode: means that within 5 minutes, continuously brush invalid card or enter wrong password ten times, the machine will lock up and alarm for 1 minute, while the button light flashes quickly and automatically calls the indoor unit. The button and card swiping are invalid during this time period. (except the call button)

Notice: If you do the above any step press “ * “Exit or return to previous level.

7). User operation

Revise PW

Press * read card+ old PW+# (default 0000, BI BI two times feedback, button slow flashlight) , NNNN (four digital number for new PW).

Punch card unlock

Brush the added valid card in the sensing area. Open the door.

Card or PW unlock

Brush the added valid card in the sensing area, or input PW+#, any one correct can unlock.

Card+PW unlock

Brush the added valid card and input right PW, both should be correct and unlock.

Wiring diagram

84207-EPC and 84207-C wiring diagram is the same.

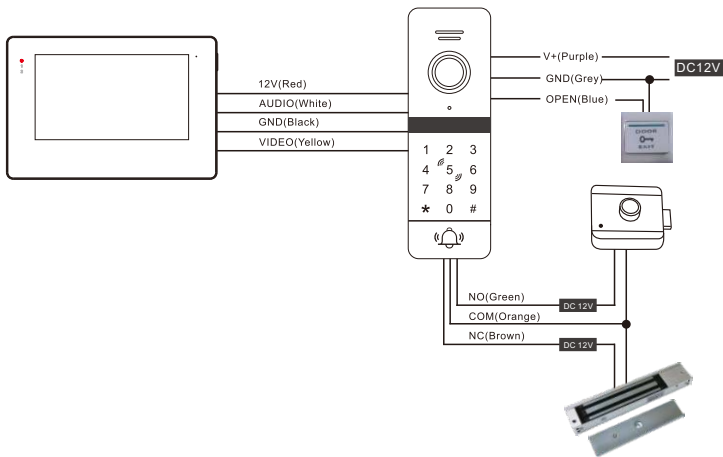

INSTALLATION DIAGRAM

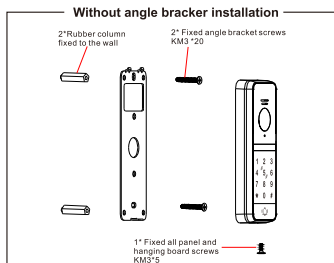
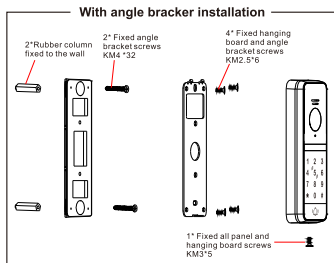

INSTALLATION PROCESS OF OUTDOOR UNITS

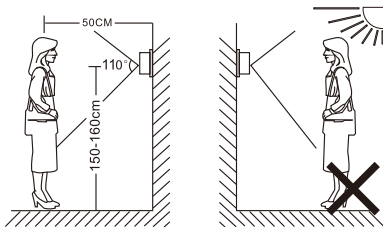

NOTE:

- Avoid installation of the device near strong radiation e.g. AC motor and lift .
- Maintenance should be complied with qualified technician .
- Avoid hard shake , beating and collision ,otherwise the internal exact components maybe be damaged .
- Do not expose the outdoor camera under strong light or sunshine.
- Do not install the outdoor camera in the environment e.g. direct sunlight ,contact rain ,High temperature ,high humidity ,full of dust and chemistry corrosive.
- Select the most suitable position where the camera is located at user's eye level
- Switch off power supply before installation.
- Keep more than 30cm away from AC power supply to avoid external interference.
- Keep it away from the water and magnetic field.