

CC6 Standalone Access Control Manual

1. Description

CC6 is a standalone access control, support card, pin, card+pin access way. It supports up to 2000 users , each user can possess one card and one pin.

It can directly drive Lock, Ring Bell, and also can connect with Exit Button.

There are 3 working mode with this device. 1. Wiegand Reader, 2. Standalone for single door, 3. Anti-passback for single door.

Besides, it also supports 1 Master code, 2 Manager cards, providing users with easy operations and safety reliability.

2. Features

1. Pure Zinc alloy case; waterproof conform to IP 68
2. Built-in 125KHz OR 13.56MHz card reader (CC6)
3. Perfect digital backlit key, the back light can be set to Normal ON, Normal OFF or Human-Approach ON
5. Add and delete card user quickly With Manager cards
6. Can register and delete user via keypad
7. Master can open the door when entering the setting status
8. Multi working modes: reader, standalone, anti-passback and so on, suitable for many occasions

3. Specification

Input Voltage AC/DC 12V

Idle Current < 25mA

Lock output load < 1A

Alarm output load < 1A

Ring bell load < 1A

Card reading distance 40mm Max

Card Frequency: 125KHz for EM and HID

13.56MHz for Mifare

Card transmission format 26-37 bit wiegand

Keypad transmission format: 4bit, 8bit and Virtual card number

Operating Temperature: -45°C ~ 55°C

Operating Humidity: 0% ~ 95%

4. Installation

- Remove the back cover from the keypad using the supplied special screw driver
 - Drill 2 holes on the wall for the Self tapping screws and 1 hole for the cable
 - Put the supplied rubber bungs to into the two holes
 - Fix the back cover firmly on the wall with 2 Self tapping screws
 - Thread the cable through the cable hole
- Attach the keypad to the back cover.

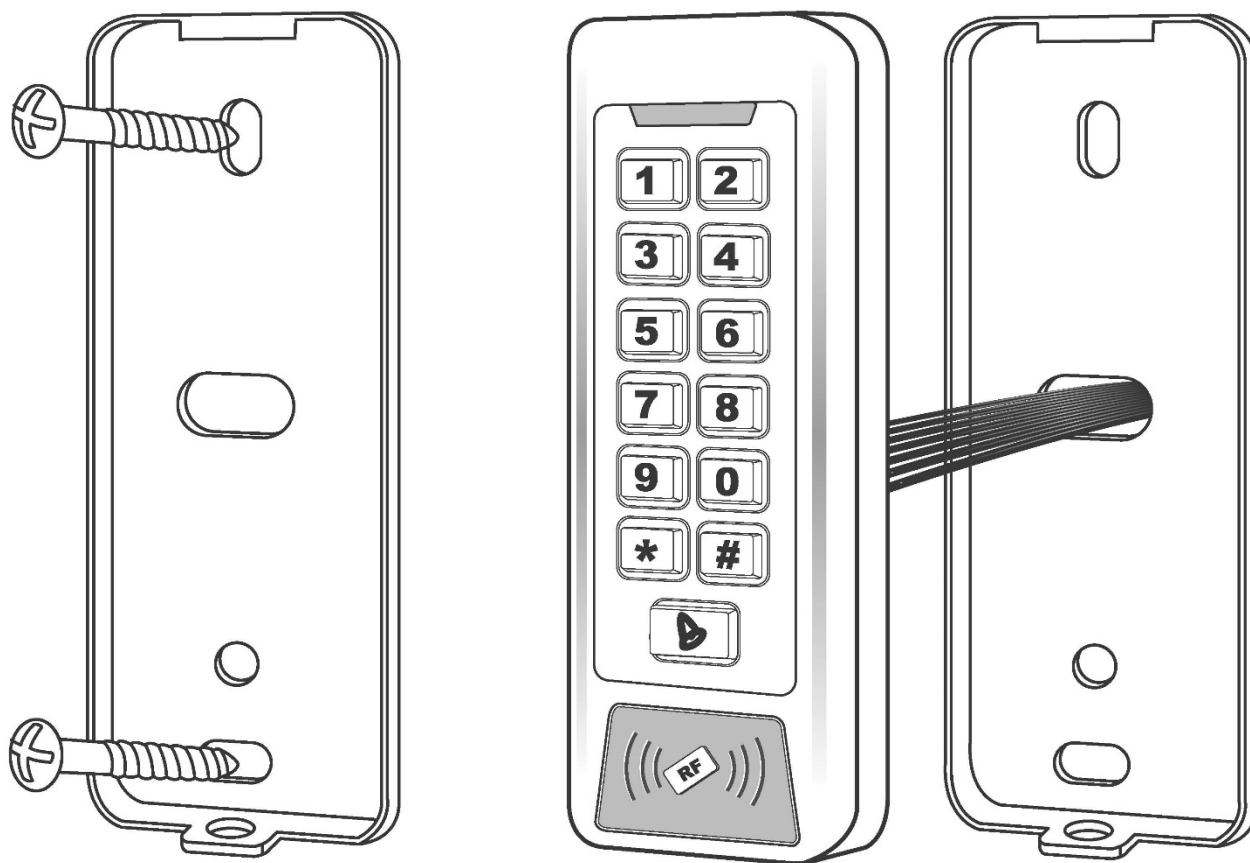

5.Wiring

No.	Colour	Marks	Description
1	orange	NC	Relay Closed end
2	purple	COM	Relay Public end
3	blue	NO	Relay normally-on end
4	yellow	OPEN	Exit button one end
5	gray	AC2	AC input
6	black	GND	GND
7	red	AC1	AC1 (+12V)
8	white	D1	Wiegand output D1
9	green	D0	Wiegand output D0
10	pink	BELL-A	Doorbell button
11	pink	BELL-B	Doorbell button

6.Sound and Light Indication

Operation	LED Color	Buzzer
Standby	Red flash	
Press key		Di
Read card	Green	Di-
Door 1 Open	Green	Di-
Operation Successful	Green	Di-
Operation Failed		DiDiDi
PIN Inputting	Red	
Card&PIN Reading	Red	
Multi Card Reading	Red	
Under Menu	Red	
Under Setting	Orange	
Manager Card Enter	Orange	DiDi
Manager Card Exit	Red Flash	Di-
Alarm	Red Quick Flash	Alarm

7 Quick Programming Guide

7.1 Administrator Setting

Stand by	Master Code	Menu	Setting	Remarks	Functions
Red Flash	Red	Red	Orange		
*	Master code#	00	New master code# Repeat new master code # (Note:Code length:6-8 digits)	Factory default:999999	Change the master code
		01	Read Manager Add Card	Default:Zone 1	Set Manager Add Card
		02	Read Manager Delete Card		Set Manager Delete Card
		07	0000#		Delete All Users
		51			Master open Lock

7.2 User setting

Standby	Master Code	Menu	Setting	Remarks	Functions
Red Flash	Red	Red	Orange		
*	Master code#	11	Read card	Users can be added continuously without exiting programming mode	To add card users
			User ID number# read card		
			Card number#		
			ID number#card number#		
			User ID number#PIN#		
		12	Read card	Users can be deleted continuously without exiting programming mode	To delete users
			User ID number#		
			Card number#		
		13	0#	Default 2	Entry by Card
			1#		Entry by card+PIN
			2#		Entry by either Card or PIN
		14	0-99#	Default 5	Set door relay time
			0#		Default 0
	15	1#	Relay Setting-Toggle mode		
		16	1-10#	Default 1	To set open door by multi cards
	17	User ID number#,card number#,card quantity#		To add a series cards users	

7.3 System Setting

Standby	Master Code	Menu	Setting	Remarks	Functions
Red Flash	Red	red	orange		
*	Master code#	30	0-15#	Default 0	To set facility code
		31	0#	When device reset to factory default ,the setting is still valid	Wiegand reader
			1#		Standalone for single door (Factory default setting)
			5#		Anti-passback for single door
		32	26-37#	Default 26	To set Wiegand format
		33	0-2#	When device reset to factory default ,the setting is still valid	To set keypad transmission format
		35	0#	Default 0	Safe mode 0
			1#		Safe mode 1
2#	Safe mode 2				

7.4 User optional setting

Standby	Master Code	Menu	Setting	Remarks	Functions
Red Flash	Red	red	orange		
*	Master code#	41	0#		Buzzer will be in silence except enter the programming mode
			1#	Default 1	Buzzer will sound when press the key
		42	0#		Disable keypad backlight
			1#		Enable keypad backlight
			2#	Default 2	Automatic mode, Normally it is off(sleeping mode) but wake up with human approach
		43	0#		LED Light Disable when stand-by status
			1#	Default 1	LED flash when stand-by status

Instruction:

- 1.Master code must be 6-8 digits,user PIN is 4-6 digits, The 1st digit of user PIN must be 1.
- 2.the user ID number is any number among 1-2000,Invalid 0 can be omitted; card number must be 8 or 10 digits,if the card number is less than 8 or 10 digits, input 0 before the card number.
- 3.Door open time is 0-99 second,0=50mS
- 4.when register one card user into the device, the device will automatically generate a PIN 1234 , this PIN cant open the door door.
- 5.when an invalid master pin is pressed the device will go back to the standby status after 5 seconds, when a valid PIN is entered it will go back to standby status after 30 seconds.
- 6.in operating the keypad, pressing # means to confirm the input digits ,In operation of a cycle adding or deleting cards, pressing # means to end the cycle operation and back the up operation; pressing * means to exit the operation.
7. When add a series cards, this unit will make the ID number and card number initial value; after adding one user, then it will increase the ID number and card number automatically ,Until the specified number of card is added.the card number must be consecutive card quantity is between 1-2000.
8. Working mode and keypad transmission format have been set before shipping, customer can change according to requirement, but when device reset to factory default, the setting is still valid.
- 9.when users is registered successfully, LED will turn green.

8. Administrator setting

Administrator setting on keypad

Press factory default:999999,

8.1 Change the master code

Press

Note: Master Code length:6~8 digits

8.2 Set Manager card

Set manager add card

Press

Set manager delete card

Press

Note: when add the new manager card, the new one will automatically cover the old card, only one manager card for one device

8.3 Delete all users

Press

Note: all users will be deleted. This is a dangerous operation, so use with care.

8.4 Set administer open lock

Set administer open Lock

Press

8.5 Users setting

8.5.1 read card to add user

Press ...

8.5.2 use ID Number and read card to add user

Press

8.5.3 use card number

Press

Note: 1.Card number must be 8 or 10 digits, if the card number is less than 8 or 10 digits, input 0 before the card number

2.Automatically increases, the user ID will be generated by the machine automatically, the range is 1 ~ 2000, and automatically search from 1 to 2000

8.5.4 Use ID number and card number to add user

Press

Note:1.ID number is 1~4 digits, the range is 1~2000, 1,01,001,0001, all these mean ID number 1.

2.add card user will generate one "1234" PIN, this PIN cant open door, only for user modify PIN

8.5.5 use ID number and PIN to add user

Press

Note: this fit PIN user, pin is irrelevant with card, the PIN is any 4-6 digits,1st digits must be 1 for Zone 1 with the exception of 1234 which is reserved.

8.6 Delete user

8.6.1 read card to delete user

Press ...

8.6.2 use ID number to delete user

Press ...

8.6.3 use card number to delete user

Press ...

8.6.4 delete all users

Press

Note: all users will be deleted.

8.7 Set opening door mode:

8.7.1 Entry is by card only

Press

8.7.2 Entry is by card and PIN together

Press

8.7.3 Entry is by card or PIN (factory default)

Press

8.8 Set door relay time

Press

Note: 0~99 is to set the door delay time 0-99 seconds, factory default is 5 seconds

8.9 Set Relay mode

Relay setting -pulse mode

Press

Every time a valid card/tag read or PIN input, the relay will operate, for the pre-set relay pulse time. (Factory default setting)

Relay setting-Toggle mode

Press

Every time a valid card/tag read or PIN input, the relay changes state, which will not turn back until read card/tag or input PIN again

8.10 Set opening door by multi cards

Press

Note: the door will be opened only after reading all the valid multi cards up to the card quantity setting. It is only for card entry mode(Factory default setting :1)

8.11 Add a series consecutive cards users

Press

Note: the card number must be consecutive card quantity is between 1~20000; card number is 10 digits or 8 digits

8.12 system setting

8.12.1 To set facility code

Press

Note: code should be 0~15, factory default setting :0

8.12.2 Wiegang Reader

Press

8.12.3 standalone for single door(Factory default setting)

Press

8.12.4 Anti-passback for Single door

Press

8.13 To set wiegang format

Press

Note: factory default setting :26

8.14 setting keypad transmission format

Press

Note: keypad transmission format is 0 1 2, factory default is 0; when device reset to factory default, the setting is still valid.

8.15 setting safe mode

8.15.1 normal mode (factory default)

Press

8.15.2 dead mode

Press

If read invalid card or input wrong PIN 10 times in 10 minutes, system will be dead for 10 mins

8.15.3 alarm mode

Press

if read invalid card or input wrong PIN 10 times in 10 minutes, built-in buzzer will work.

8.16 user optional setting

8.16.1 setting keypad tone OFF or ON

Press

The device will be in silence except enter the programming mode

Press

The device will give the voice when press the keys (Factory default setting)

8.16.2 setting keypad backlight

Disable keypad backlight

Press

Enable keypad backlight

Press

Automatic mode (factory default setting)

Press

Normally it is off(sleeping mode) but wake up with human approach

8.16.3 setting LED light (stand-by status)

Disable LED light

Press

Flash LED light (factory default setting)

Press

Manager card operation

8.17 add user

Read Manager Add Card, read user cards continuously, read Manager Add card again.

8.18 delete user

Read Manager Delete Card, read user cards continuously, read Manager Delete card again.

9 User Operation

9.1 Entry by card mode, Set multi cards to open door when card quantity is 1

Read user card, lock will be unlocked

9.2 Entry by card mode, Set multi cards to open door when card quantity is 2-10

Read these cards one by one, present each card in 5 seconds, lock will be unlocked

9.3 Entry by card and PIN

Present card, then press PIN(4 to 6 digits), #, lock will be unlocked

9.4 Entry by card or PIN mode

Present card, lock will be unlocked

Or Press PIN(4 to 6 digits), #, lock will be unlocked

9.5 Relay mode

Relay setting -pulse mode

every time a valid card/tag read or PIN input, the relay will operate, for the pre-set relay pulse time.

Relay setting-Toggle mode

Every time a valid card/tag read or PIN input, the relay changes state, which will not turn back until read card/tag or input PIN again

9.6 Modify user PIN (no need enter programming mode)

*, read user card, press old PIN, #, new PIN # new PIN #

Or *, press ID number # old PIN# new PIN # new PIN #

Notice: user who don't have user card must get ID number and origin PIN from Admin, users PIN must start with 1.

10 Multi working mode:

There are 3 working mode with this device.

1. Wiegand Reader

2. Standalone for single door

3. Anti-passback for single door

The factory default is Standalone for single door (we can change the default model according to customer order). User can modify the working mode, when the device reset to factory default, the setting is still valid.

10.1 Wiegand Reader mode

In this mode, the access control works as reader, connected with the common access controller, it has following function.

Modify master pin

Set facility code

Set the card transmission format

Set the keypad transmission format

Set optional setting

When LED level is low, indicator light(LED) will turn into green, after 30 seconds or LED level rising, LED will back to normal.

When BZ level is low, the buzzer will beep, after 30 seconds or BZ level rising, the buzzer will back to normal.

When it used as the reader, both card number and keypad transmits in Wiegand format, the output data are shown by the low level of DO&D1 wire:

D0: low level means 0, green wire

D1:Low level means 1,white wire

The Pulse width of low level is 100uS,bit period is 1.6mS

The digits of card number can be set to 26-37 bit, should be matched with the controller.(Factory default is 26Bit)

Keypad transmission can be set in the following 3 modes(modes can be set by user)

Model 0: Virtual card number

The reader will transmit the PIN data when it receives the last key(#) press after PIN code

Format: Decimal card number with 10 digits, Facility code(1st~4th digit)+PIN Code(5th-10th digit)

Facility code is any digits between 0~15,PIN code is 4~6 digits

Example: facility code :15

PIN code:9999

Press 9999 #, then output format will be: 0015009999

PIN code: 999999

Press 999999#,then output format will be 0015999999

Model 1: 4 Bit

The output data is provided in following format after every key is pressed:

key	Output in hex	Output in Binary
0	0	0000
1	1	0001
2	2	0010
3	3	0011
4	4	0100
5	5	0101
6	6	0110
7	7	0111
8	8	1000
9	9	1001
*	A	1010
#	B	1011

Model 2: 8 Bit

The output data is transmitted in following format after every key is pressed:

key	Output in hex	Output in Binary
0	0	11110000
1	1	11100001
2	2	11010010
3	3	11000011
4	4	10110100
5	5	10100101
6	6	10010110

7	7	10000111
8	8	01111000
9	9	01101001
*	A	01011010
#	B	01001011

10.2 Standalone for single door

In this mode, the device supports connecting external card reader for exiting door. The users of this device or external reader can open the door by valid card or PIN.

10.3 Anti-passback for Single door

In this mode, this unit install outside is for entering door, external reader inside for exiting door, the users can only enter door when read valid card on the machine, and exit from the inside external reader. If without the entering record from the machine, the users can not exit from the inside reader, also the Users can't enter in twice without the first exit record.

11 Diagram for 3 working mode

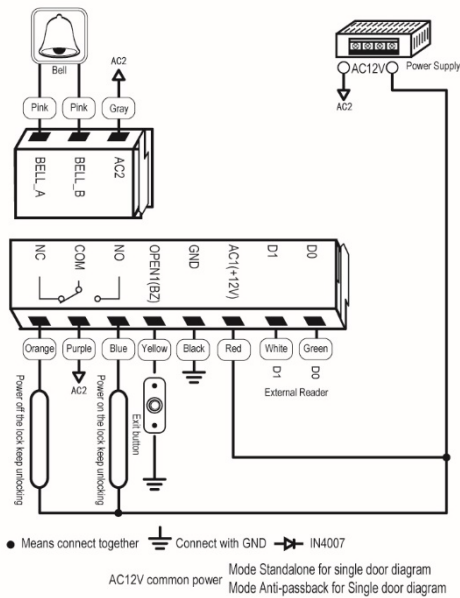

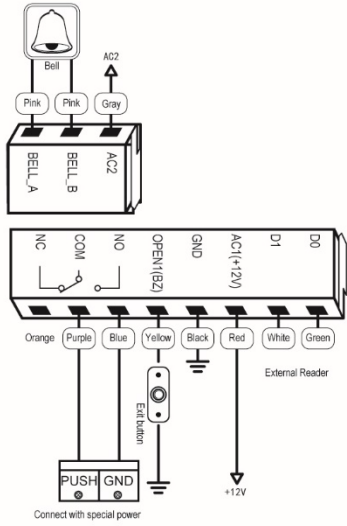

● Means connect together Connect with GND IN4007

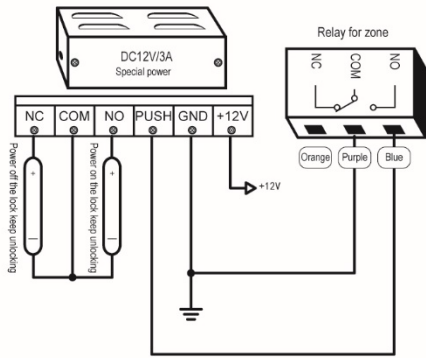

special power with Lock 1 diagram

DC12V special power Mode Standalone for single door diagram
Mode Anti-passback for Single door diagram

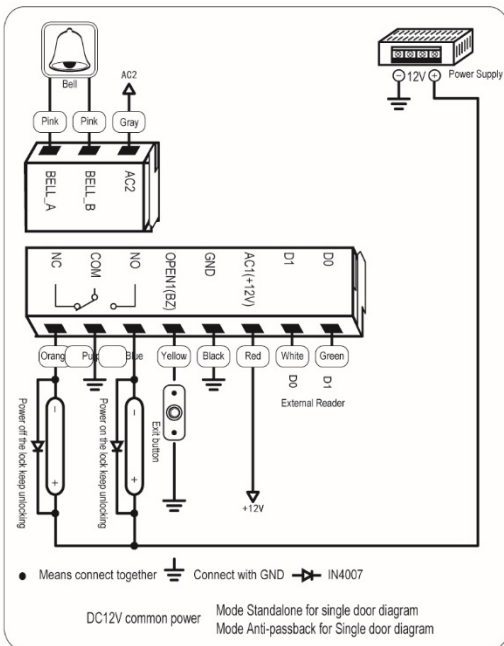

● Means connect together Connect with GND IN4007

DC12V common power Mode Standalone for single door diagram
Mode Anti-passback for Single door diagram

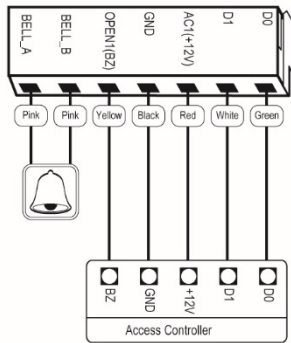

Mode Wiegand reader diagram

12 To Reset to Factory Default

- Disconnect power from the unit
- Press and hold # key whilst powering the unit back up
- On hearing two “Di” release # key, system is now back factory settings

Please note only installer data is restored, user data will not be affected

13 Packing List

Name	Model/size	Quantity	Remarks
Keypad	CC6/CC2	1	
User manual	CC6/CC2	1	
Self tapping screws	Φ4mm×27 mm	2	Used in fixing
Rubber plug	Φ6mm×30 mm	2	Used in fixing
Star screw driver	Φ20mm×60mm	1	Special for Keypad
two-electrode valve	1N4007	1	

Warm Tips

- * Please do not to repair the device privately, if have problem, please return to the supplier.
- *Before installation on wall, please check carefully concealed wiring or wire tube, in case of he trouble from broken concealed wiring etc when drilling, please use safe glasses when drilling or fixed line clip.
- * if the product update, manual may be different, Without Prior Notice.